

QPI-1 ASSEMBLY

DESCRIPTION

The 93480 QPI-1 Assembly is a multi-purpose, electrically fired initiator with a pressure output. It is a two pin or single bridge wire device initiated when a minimum of 1.50 amps is applied for 5 milliseconds maximum. There is a -01 version that is a live unit and the -02 which is inert for testing purposes. The inert unit will be marked with a blue highlighter on the cup end face.

PERFORMANCE

Output:	520±175 PSI when fired in a 10 CM ³ closed volume bomb
Operating Temperature:	-50°F to +150°F
Initiator Seal:	1 x 10 ⁻⁶ CC/SEC Helium Maximum (or Equiv.)

ELECTRICAL AND FIRING DATA

No-Fire:	The maximum no fire constant current required to exhibit a reliability of .999 at a confidence level of 95% shall be .35 amperes minimum, applied for 5 minutes on units conditioned at 150°F ±10°F for two hours minimum.
All-Fire:	The minimum all fire constant current required to exhibit a reliability of .999 at a confidence level of 95% shall be a maximum of 1.50 amperes, applied for 5 milliseconds maximum on units conditioned at -50°F ±10°F for two hours minimum.



ELECTRICAL AND FIRING DATA continued

Bridgewire Resistance:	0.985 ±0.095 OHMS
Insulation Resistance, Pins-to-Case:	100 MEG OHMS minimum at 500 volts DC
Electrostatic Discharge, No-Fire:	25,000 volts from a 500 Picofarad capacitor thru a 5,000 OHM resistor in series, pin-to-pin
Thermal Transient Test (TTT) 250 mA for 80 mS:	1.0mV to 9.0mV

ENVELOPE & DIMENSIONS

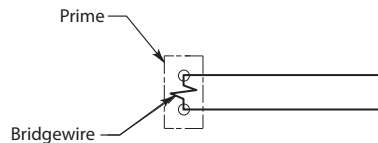
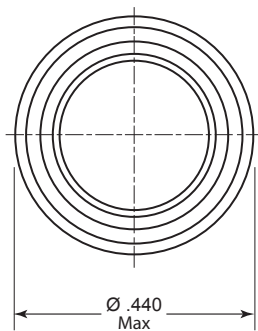

SCHMATIC

